

Details of the booth fittings:

BOOTH "SUPERIOR 16"

EXTERIOR

- 1 No. 3 lockable showcases (internal net dimension: cm 50x35x50 h, each), with appropriate lighting; showcase interior in light beige alcantara; no. 2 dichroic warm spotlights (50W) and no. 1 dichroic cool spotlight (50 W) will be provided per each showcase.
- 2 No. 1 backlight reproduction of the company naming (and Country identification, referred to the only Country Pavilions).
- 3 Exterior walls in dark wengè and beige coloured fabric, lockable entrance door in wengè

Fittings include:

- Carpeted floor.
- No. 1 wastepaper bin.
- No. 1 220V socket, located underneath the worktable.

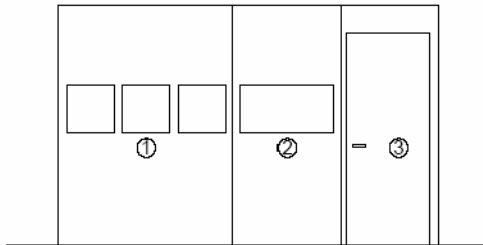

INTERIOR

- 4 No. 1 worktable (dimension cm 160x70x75 h), connected with no.1 lockable showcase (dimension cm 118x68x37 h); showcase interior in light beige alcantara; led lighting with cool spotlight will be provided per each showcase.
- 5 No. 4 chairs
- 6 No. 1 high wall unit (dimension cm 180x62x210 h) equipped with: safe (*), clothes stand and storage components with shelves; no. 1 low wall unit with inside shelves (dimension: cm 195x62x75 h).
- 7 Customized graphics printing representing the corporate image (dimension: cm 150x100 h), wall hanging(*).
- 8 No. 1 table lamp.
- 9 General lighting with flexible spotlights, attached at the wall.

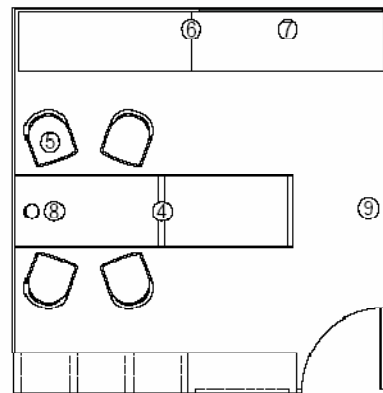

*Available on request at an additional cost and provided exclusively by Fiera di Vicenza S.p.A.
All further details will be forwarded with the application form.

BOOTH "SUPERIOR 20"

EXTERIOR

- 1 No. 3 lockable showcases (internal net dimension: cm 50x35x50 h, each), with appropriate lighting; showcase interior in light beige alcantara; no. 2 dichroic warm spotlights (50W) and no. 1 dichroic cool spotlight (50 W) will be provided per each showcase.
- 2 No. 1 backlight reproduction of the company naming (and Country identification, referred to the only Country Pavilions).
- 3 No. 1 exterior wall unit in dark brown wenge coloured fabric, lockable entrance door in wengè.

Fittings include:

- Carpeted floor.
- No. 1 wastepaper bin.
- No. 1 220V socket, located underneath the worktable.

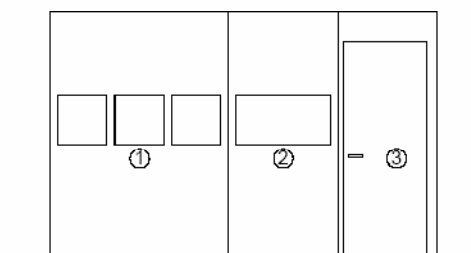

INTERIOR

- 4 No. 1 worktable (dimension cm 160x70x75 h), connected with no. 1 lockable showcase (dimension cm 118x68x37 h); showcase interior in light beige alcantara; led lighting with cool spotlight will be provided per each showcase.
- 5 No. 4 chairs
- 6 No. 1 high wall unit (dimension cm 180x62x210 h) equipped with: safe (*), clothes stand and storage components with shelves; no. 1 low wall unit with inside integrated illumination (dimension cm 105x62x75 h).
- 7 Customized graphics printing representing the corporate image (dimension: cm 150x100 h), wall hanging(*).
- 8 No. 1 table lamp.
- 9 General lighting with flexible spotlights, attached at the wall.

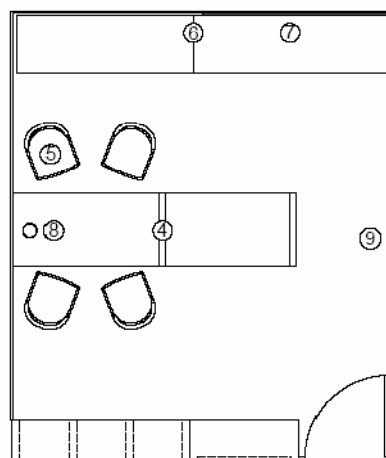

*Available on request at an additional cost and provided exclusively by Fiera di Vicenza S.p.A.
All further details will be forwarded with the application form.